

FLAT D4 | 3B 2T

Available in Tower D

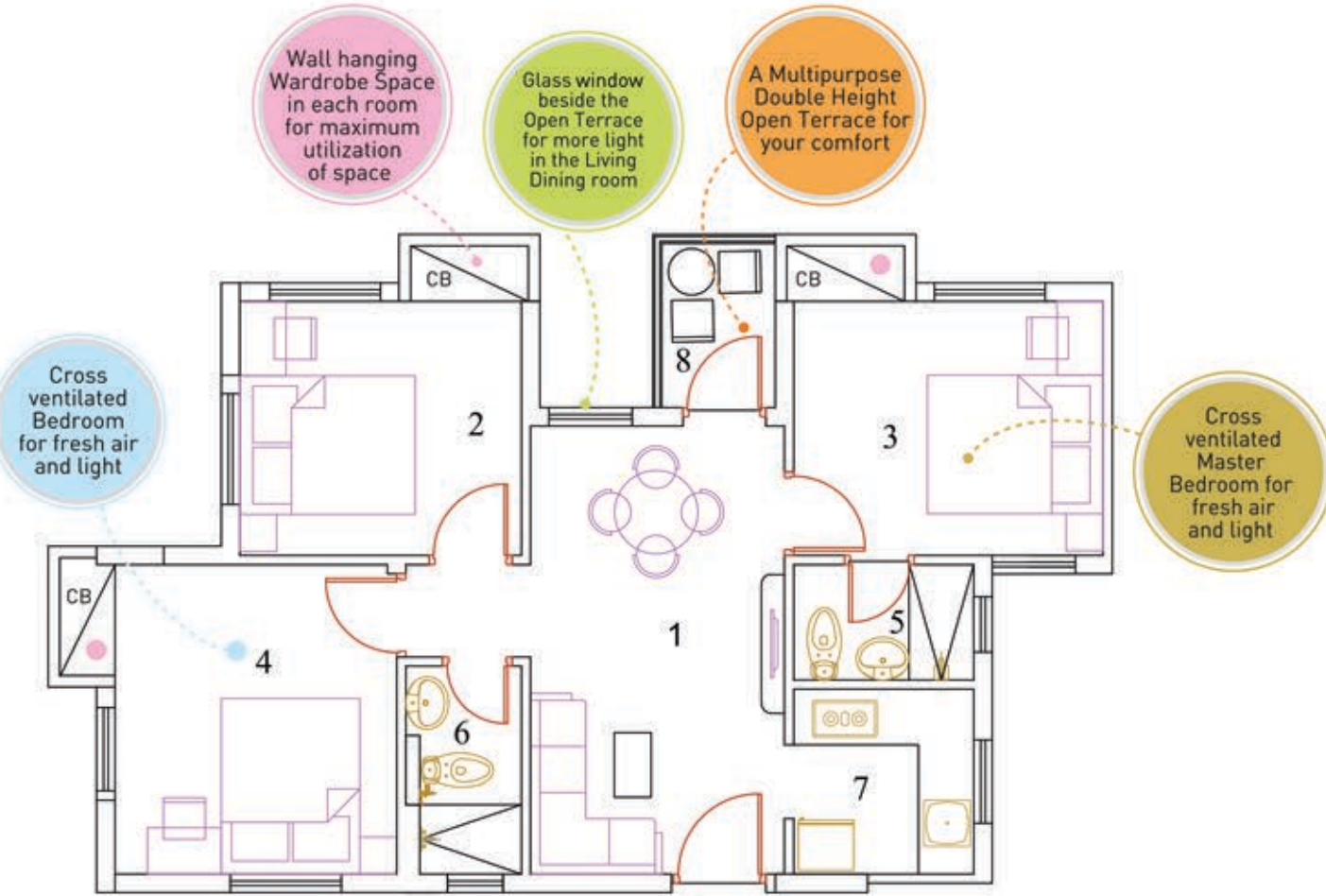

Carpet area 601 sq.ft
Carpet area + Balcony 627 sq.ft
Built up area 700 sq.ft
Standard built up area 970 sq.ft

1	Living/Dining	15'-11" X 9'-0"
2	Bed room	11'-0" X 10'-0" [9'-0" X 10'-0" without CBI]
3	Bed room	11'-0" X 11'-0" [9'-0" X 11'-0" without CBI]
4	Bed room	12'-0" X 11'-0" [10'-0" X 11'-0" without CBI]
5	Toilet	6'-5" X 4'-1"
6	Toilet	7'-5" X 4'-1"
7	Kitchen	6'-7" X 6'-5"
8	Open terrace	6'-2" X 4'-4"